

CHAINS

ESTABLISHED CORNERS FOR OREGON STATE BOARD OF FORESTRY
(See official plat)

Center East One-sixteenth corner for Section 10,
T1N, R10W, W.M., Tillamook County, Oregon.

ESTABLISHED

Var. 21 1/2 E

Set 1 1/2" x 36" galvanized iron pipe with 3" bronze cap marked "OREGON STATE BOARD OF FORESTRY E 1/16 C---C S10 1961 RS401", 34 inches in ground, and from which a:

- 15" Hemlock bears S72W 8.2 ft.; scribed CE 1/16 S10 BT.
- 14" Hemlock bears N21 1/2 W 21.3 ft.; scribed CE 1/16 S10 BT RS401.

Set 4" x 4" x 52" white painted Cedar post 1.0 ft. NE of corner pipe. Oregon State Board of Forestry metal location poster on 14" Hemlock BT N21 1/2 W.

* * * * *

Southeast One-sixteenth corner for Section 10, T1N,
R10W, W.M., Tillamook County, Oregon.

ESTABLISHED

Var. 21 1/2 E

Set 1 1/2" x 36" galvanized iron pipe with 3" bronze cap marked "OREGON STATE BOARD OF FORESTRY SE 1/16 S10 1961 RS401", 33 inches in ground, in mound of rock, and from which a:

- 29" Hemlock bears N48W 14.1 ft.; scribed SE 1/16 S10 BT RS401.
- 46" Cedar bears N14W 39.3 ft.; scribed SE 1/16 S10 BT.

Set 4" x 4" x 52" white painted Cedar post 1.0 ft. NW of corner pipe. Oregon State Board of Forestry metal location poster on 46" Cedar BT.

Dated February 27, 1961

Established by

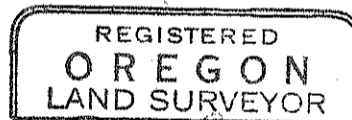

Richard A. Morris

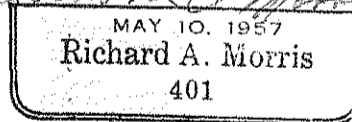

Present and witnessed by H. Russell
R. Cop
E. Nylund

472